

TXH™ TIG torches

Torches and consumables

TXH™ TIG torches for the demanding welder

The main characteristic of the TXH™ torches is above all their quality. The torches and torch fittings offer a maximum amount of convenience, versatility and ergonomics.

You can vary between air- or water-cooled, with or without gas-valve and with or without flexible neck to suite your individual application.



Ordering information Self-cooled torches

TXH™ 121, 4 m OKC 50	0700 300 524
TXH™ 121, 8 m OKC 50	0700 300 529
TXH™ 151, 4 m OKC 50	0700 300 538
TXH™ 151, 8 m OKC 50	0700 300 544
TXH™ 201, 4 m OKC 50	0700 300 552
TXH™ 201, 8 m OKC 50	0700 300 555
TXH™ 121, 4 m OKC 25 C	0700 300 522**
TXH™ 121, 8 m OKC 25 C	0700 300 527**
TXH™ 121, 4 m OKC 25	0700 300 532*
TXH™ 121, 8 m OKC 25	0700 300 534
TXH™ 151, 4 m OKC 25	0700 300 548*
TXH™ 151, 8 m OKC 25	0700 300 550*
TXH™ 151, 4 m OKC 25 C	0700 300 536**
TXH™ 151, 8 m OKC 25 C	0700 300 542**
TXH™ 201, 4 m OKC 25	0700 300 558
TXH™ 201, 8 m OKC 25	0700 300 560

* Only Origo Tig 150i

** Only Caddy Tig 150i

With gas valve

TXH™ 121V, 4 m OKC 25	0700 300 523
TXH™ 121V, 8 m OKC 25	0700 300 528
TXH™ 151V, 4 m OKC 25	0700 300 537
TXH™ 151V, 8 m OKC 25	0700 300 543
TXH™ 151V, 4 m OKC 50	0700 300 539
TXH™ 151V, 8 m OKC 50	0700 300 545
TXH™ 201V, 4 m OKC 50	0700 300 553
TXH™ 201V, 8 m OKC 50	0700 300 556

With flexible head

TXH™ 121F, 4 m OKC 25	0700 300 525
TXH™ 121F, 8 m OKC 25	0700 300 530
TXH™ 121F, 4 m OKC 50	0700 300 526
TXH™ 121F, 8 m OKC 50	0700 300 531
TXH™ 151F, 4 m OKC 25	0700 300 540
TXH™ 151F, 8 m OKC 25	0700 300 546
TXH™ 151F, 4 m OKC 50	0700 300 541
TXH™ 151F, 8 m OKC 50	0700 300 547
TXH™ 201F, 4 m OKC 25	0700 300 559
TXH™ 201F, 4 m OKC 50	0700 300 554
TXH™ 201F, 8 m OKC 50	0700 300 557

With current adjustment*

TXH™ 121r, 4 m OKC 50	0700 300 620
TXH™ 121r, 8 m OKC 50	0700 300 622
TXH™ 151r, 4 m OKC 50	0700 300 624
TXH™ 151r, 8 m OKC 50	0700 300 626
TXH™ 201r, 4 m OKC 50	0700 300 628
TXH™ 201r, 8 m OKC 50	0700 300 630

With flexible head and current adjustment*

TXH™ 121Fr, 4 m OKC 50	0700 300 621
TXH™ 121Fr, 8 m OKC 50	0700 300 623
TXH™ 151Fr, 4 m OKC 50	0700 300 625
TXH™ 151Fr, 8 m OKC 50	0700 300 627
TXH™ 201Fr, 4 m OKC 50	0700 300 629

Ordering information Water cooled torches

TXH™ 251w, 4 m OKC 50	0700 300 561
TXH™ 251w, 8 m OKC 50	0700 300 563
TXH™ 401w, 4 m OKC 50	0700 300 565
TXH™ 401w, 8 m OKC 50	0700 300 567
TXH™ 401w HD, 4 m OKC 50	0700 300 566
TXH™ 401w HD, 8 m OKC 50	0700 300 568

With flexible head

TXH™ 251wF, 4 m OKC 50	0700 300 562
TXH™ 251wF, 4 m OKC 50	0700 300 564

With current adjustment*

TXH™ 251wr, 4 m OKC 50	0700 300 632
TXH™ 251wr, 8 m OKC 50	0700 300 634
TXH™ 401wr, 4 m OKC 50	0700 300 636
TXH™ 401wr, HD 4 m OKC 50	0700 300 637
TXH™ 401wr, 8 m OKC 50	0700 300 638
TXH™ 401wr HD, 8 m OKC 50	0700 300 639

With flexible head and current adjustment*

TXH™ 251wFr, 4 m OKC 50	0700 300 633
TXH™ 251wFr, 8 m OKC 50	0700 300 635

Accessories

Adapter for remote-controller torches

12 poles	0459 491 912
10 poles for Origo™ Tig 3001i	0459 491 913
Adapter for old ESAB machines with central connector	0466 807 880
Cooling liquid (10 l)	0007 810 012
Wear part kit for TXH™ 121/251w	0368 846 880
Wear part kit for TXH™ 151/201	0368 846 881

Extensions

Special extensions, not for torches with current adjustment

Length 8 m, 200 A, self-cooled	0466 705 880
Length 16 m, 200 A, self-cooled	0466 705 882
Length 16 m, 400 A, water-cooled	0466 705 883

* See Accessories page 67 for suited adapter

Technical data	TXH™ 121	TXH™ 151	TXH™ 201	TXH™ 251w	TXH™ 401w	TXH™ 401w HD
Maximum current						
35% duty cycle, A	-	150	200	-	-	-
60% duty cycle, A	120	120	150	-	-	-
100% duty cycle, A	100	100	140	250	400	400
Electrode diameter, Ø mm	1,0 - 3,2	1,0 - 3,2	1,0 - 4,0	1,0 - 3,2	1,0 - 4,8	1,0 - 4,8

Wear parts	Torches TXH™		121/251w	151/201	401w/401wHD
------------	--------------	--	----------	---------	-------------

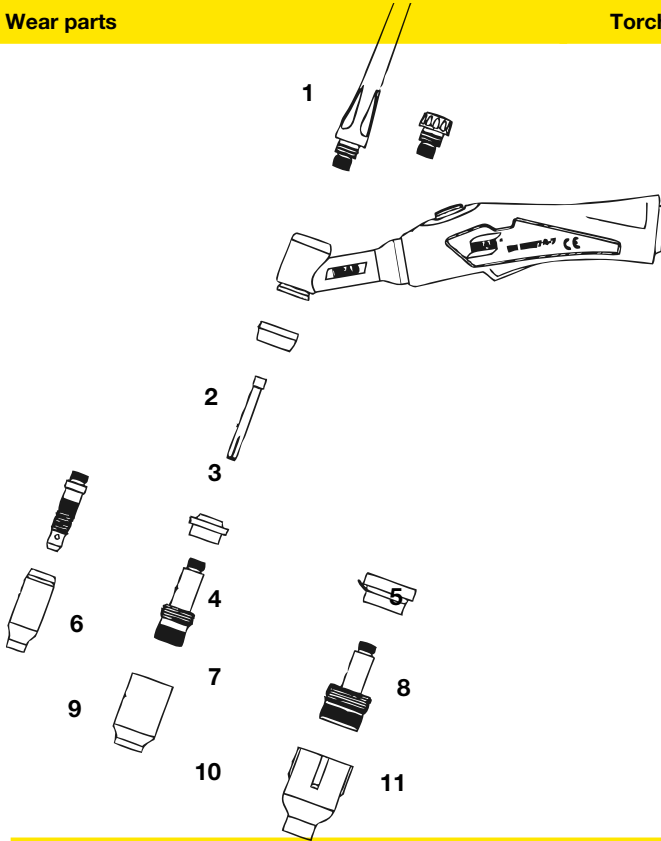

Collet body with gas lens (7)

Ø 1,0	0157 121 016	0157 123 021	0157 123 091
Ø 1,6	0157 121 017	0157 123 022	0157 123 092
Ø 2,4	0157 121 018	0157 123 023	0157 123 093
Ø 3,2	0157 121 041	0157 123 024	0157 123 094
Ø 4,0	-	0157 123 025	0157 123 095
Ø 4,8	-	-	0157 123 075

Collet body with extra large gas lens (7)

Ø 1,6	-	0157 123 084	-
Ø 2,4	-	0157 123 085	-
Ø 3,2	-	0157 123 086	-
Ø 4,0 - 4,8	-	0157 123 087	-

Gas nozzles, standard (8)

Ø 6,4	0365 310 044	0157 123 052	-
Ø 8,0	0365 310 045	0157 123 053	-
Ø 9,8	0365 310 046	0157 123 054	-
Ø 11,2	0365 310 047	0157 123 055	-
Ø 12,7	0365 310 048	0157 123 056	-
Ø 15,9	0588 000 440	0588 000 442	-
Ø 19,0	-	0588 000 441	-

5 – Gas nozzle for gas lens (10)

Ø 6,4	0157 121 032	0157 123 057	0157 123 057
Ø 8,0	0157 121 033	0157 123 058	0157 123 058
Ø 9,8	0157 121 034	0157 123 059	0157 123 059
Ø 11,2	0157 121 039	0157 123 060	0157 123 060
Ø 12,7	0157 121 040	0157 123 061	0157 123 061
Ø 17,5	-	0588 000 439	-

Extra large gas nozzle for extra large gas lens (11)

Ø 9,8	-	0157 123 088	-
Ø 12,7	-	0157 123 089	-
Ø 15,9	-	0588 000 438	-
Ø 19,0	-	0157 123 098	-
Ø 24,0	-	0588 000 437	-

In bold: standard delivery

Torches TXH™	121/251w	151/201	401w/401wHD
--------------	----------	---------	-------------

Back cap (1)

Long	0365 310 051	0157 123 029	0157 123 029
Medium	0365 310 050	0588 000 591	0588 000 591
Short	0365 310 049	0157 123 028	0157 123 028

Heat shield

(2)	0366 960 017	0366 960 016	0366 960 018
(4)	-	0366 960 020	-
(5) extra large gas lens	-	0366 960 021	-

Collet, standard and for gas lens (3)

Ø 1,0	0365 310 028	0157 123 010	0157 123 010
Ø 1,6	0365 310 029	0157 123 011	0157 123 011
Ø 2,4	0365 310 030	0157 123 012	-
Ø 3,2	0365 310 091	0157 123 013	-
Ø 4,0	-	0157 123 014	-

Collet body, heavy duty

Ø 2,4	-	-	0157 123 077
Ø 3,2	-	-	0157 123 078
Ø 4,0	-	-	0157 123 079
Ø 4,8	-	-	0157 123 074

Collet body, standard (6)

Ø 1,0	0365 310 037	0157 123 015	-
Ø 1,6	0365 310 038	0157 123 016	-
Ø 2,4	0365 310 039	0157 123 017	-
Ø 3,2	0365 310 090	0157 123 018	-
Ø 4,0 - 4,8	-	0157 123 019	-
Ø 0,5 - 2,4	-	-	0157 123 081
Ø 3,2 - 4,0	-	-	0157 123 082



Tungsten electrodes: see ESAB Accessories catalogue